

Drainage channel pipe:
 Ø 50 mm
 Ø 2 in

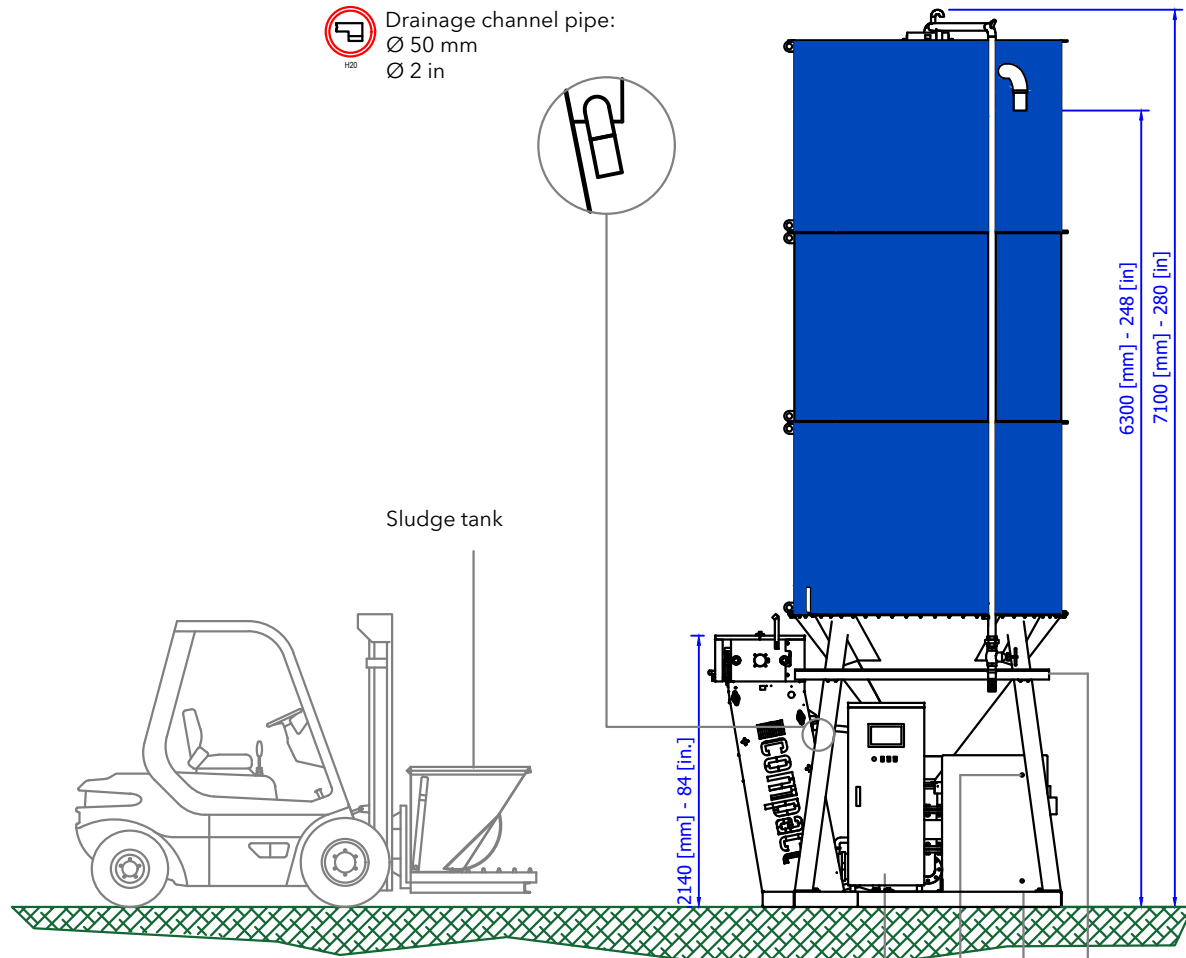

Clarified water unloading pipe:
 Ø 102 mm
 Ø 4 in

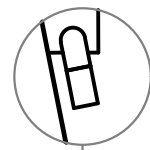

Wastewater loading pipe:
 Ø 60 mm
 Ø 2.4 in

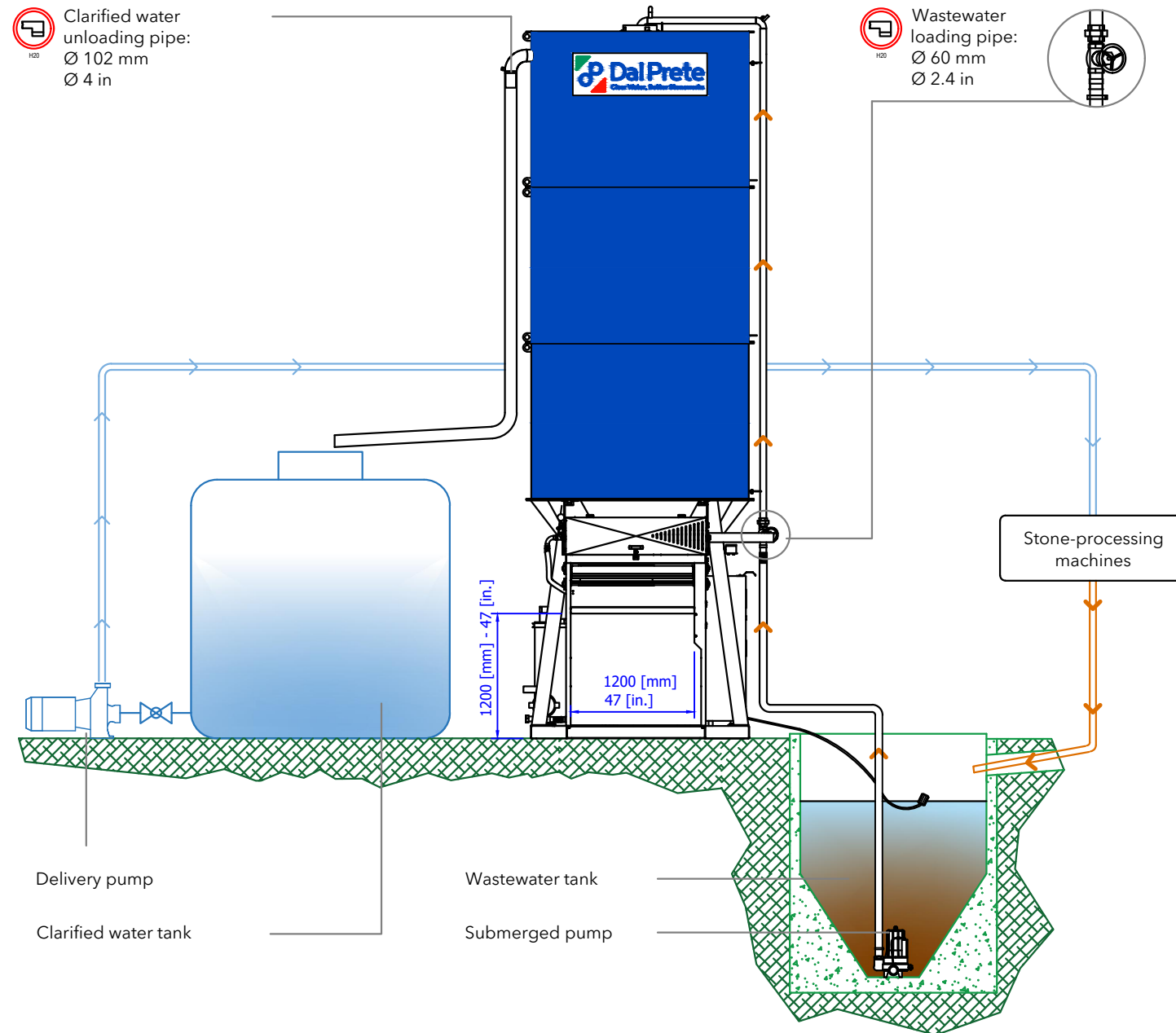
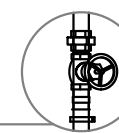

Electric supply connection:
 AC 400V; 50HZ; 3PH+PE 6.5kW; 15A

Compressed air supply:
 Ø10mm-3/8"

Flocculant station inlet: F1/2".
 Use pure water only.

Flocculant station discharge: F3/4"

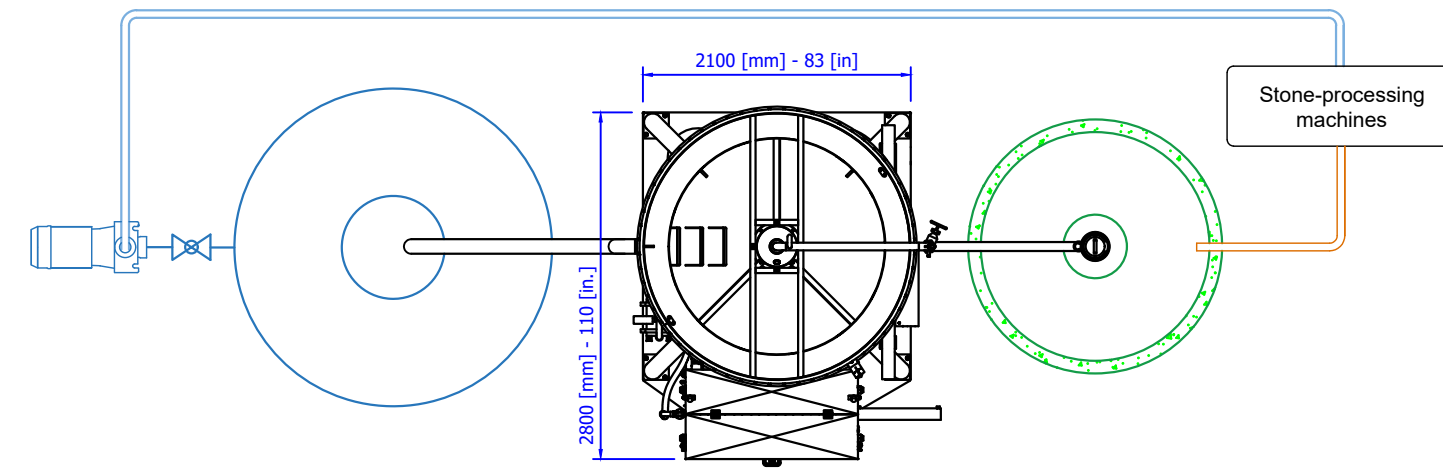
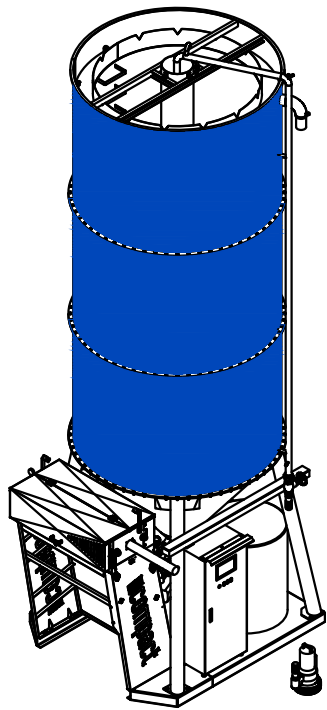

MACCHINA TIPO:
 MACHINE TYPE:

Water clarification and sludge dehydration plant

MINI COMPACT L 2.1 750L

Serial Number: _____

CLIENTE:
 CUSTOMER:

LAY-OUT DI MASSIMA
 (plant lay-out)

CODICE DISEGNO
 (drawing code)

DATA
 (date)

APPROVATO
 (approved)

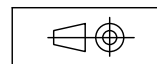

P.P.E. must be used

