

Clarified water unloading pipe:
Ø102mm-4in



Wastewater loading pipe:
Ø60mm-2.4in



Drainage channel pipe:
Ø50mm-2in

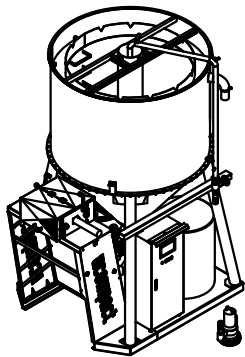
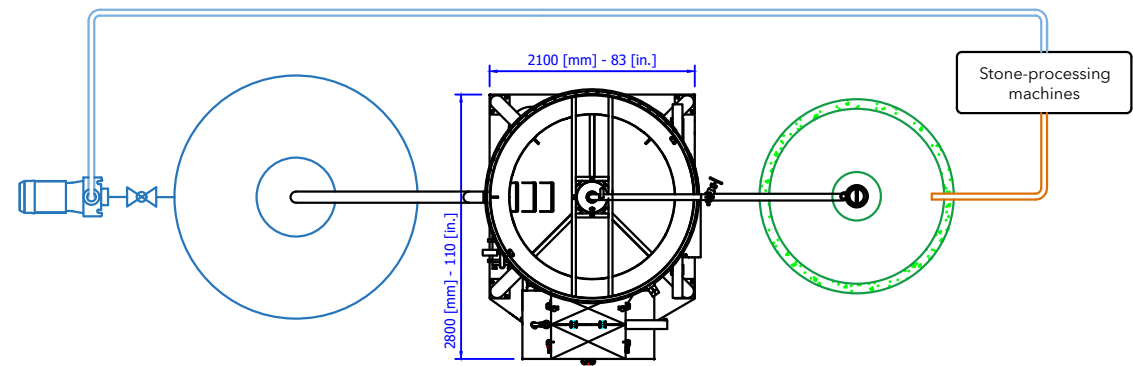
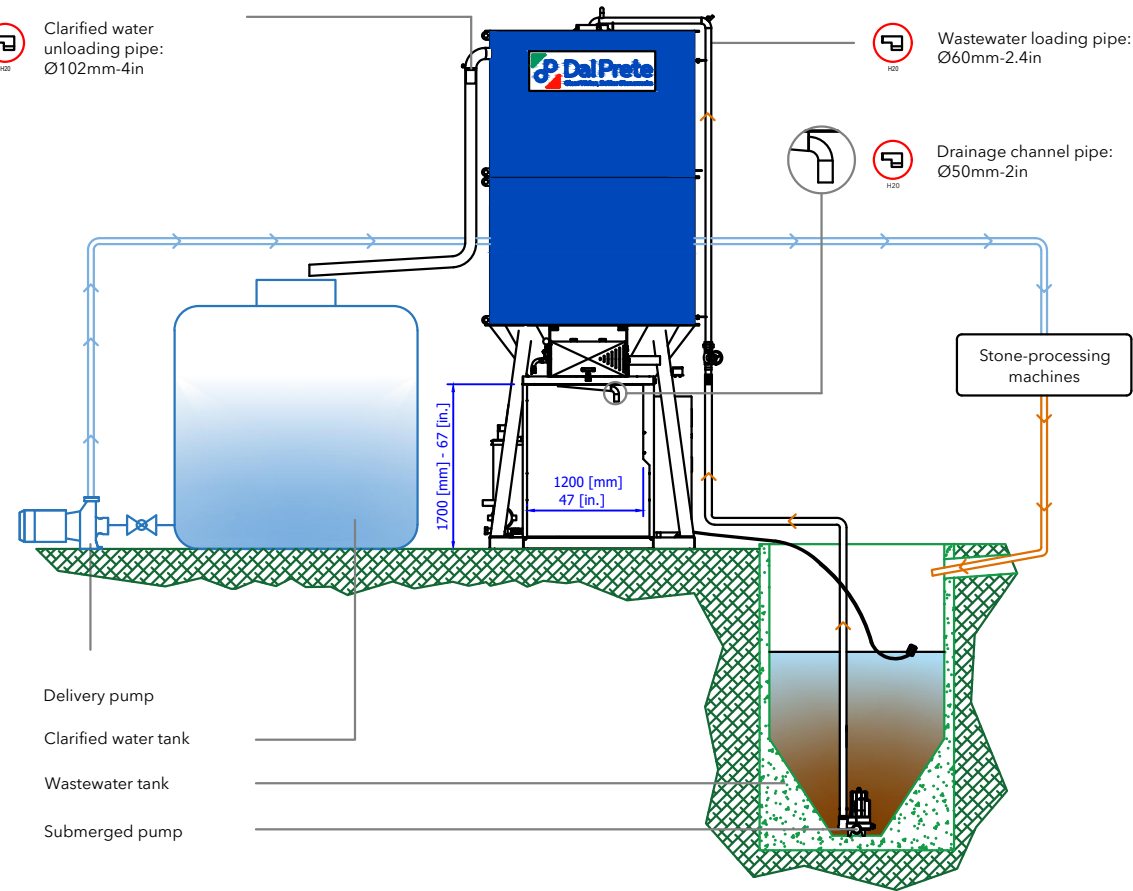

Electric supply connection:
AC 400V; 50HZ; 3PH+PE 6.5kW; 15A



Flocculant station inlet:
F1/2"
Use pure water only.



Flocculant station discharge:
F3/4"



Compressed air supply:
Ø10mm-3/8"

MACCHINA TIPO:
MACHINE TYPE:

Water clarification and sludge dehydration plant

MINI COMPACT M 2.1 600L

Serial Number: - - - -

CLIENTE:
CUSTOMER:

LAY-OUT DI MASSIMA
(plant lay-out)

CODICE DISEGNO
(drawing code)

DATA
(date)

APPROVATO
(approved)

