

Clarified water unloading pipe:
Ø102mm-Ø4in

Wastewater loading pipe:
Ø60mm-2.4in

Drainage channel pipe:
Ø60mm-Ø2.4in

Compressed air supply:
Ø10mm-3/8"

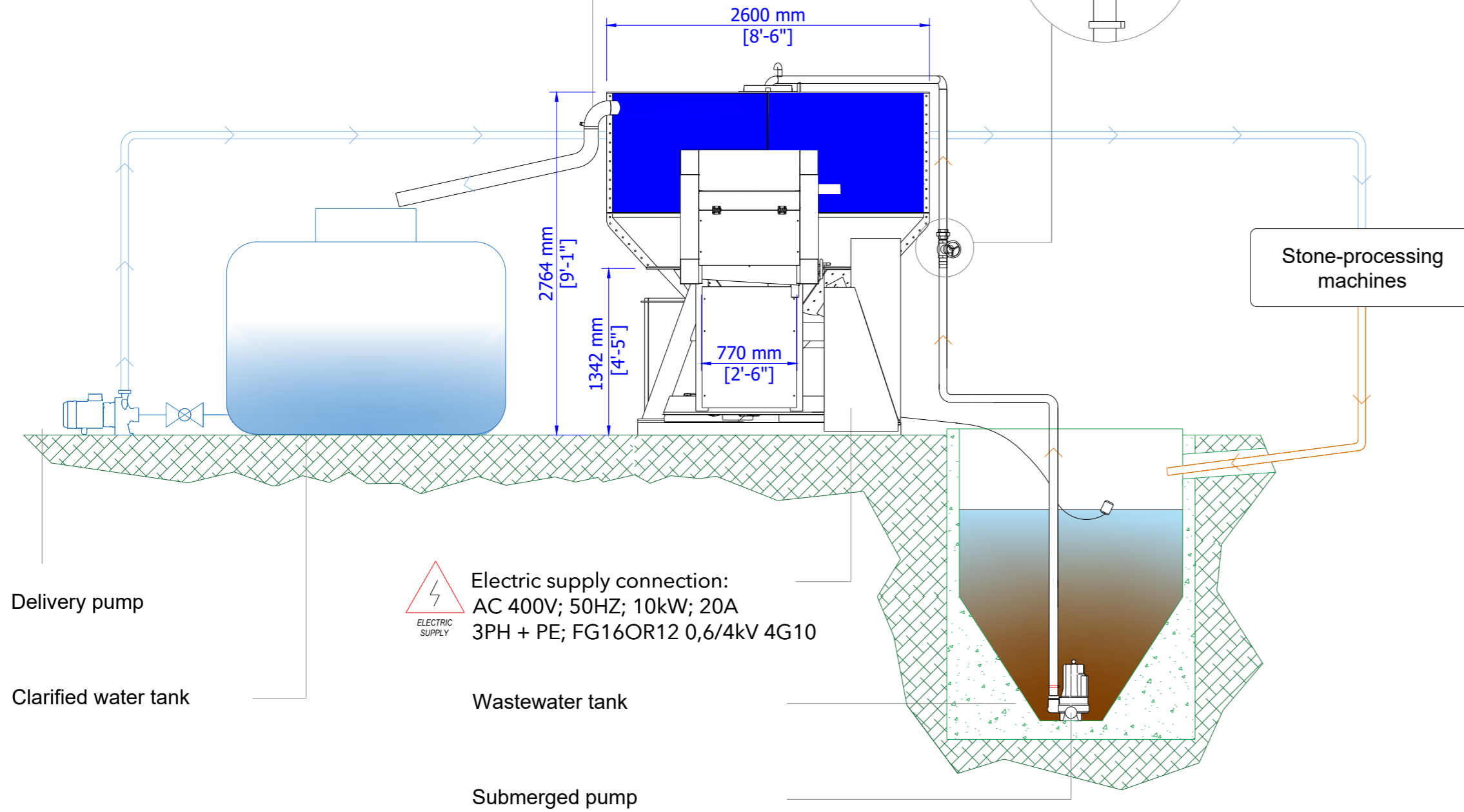

ELECTRIC SUPPLY
Electric supply connection:
AC 400V; 50HZ; 10kW; 20A
3PH + PE; FG16OR12 0,6/4kV 4G10

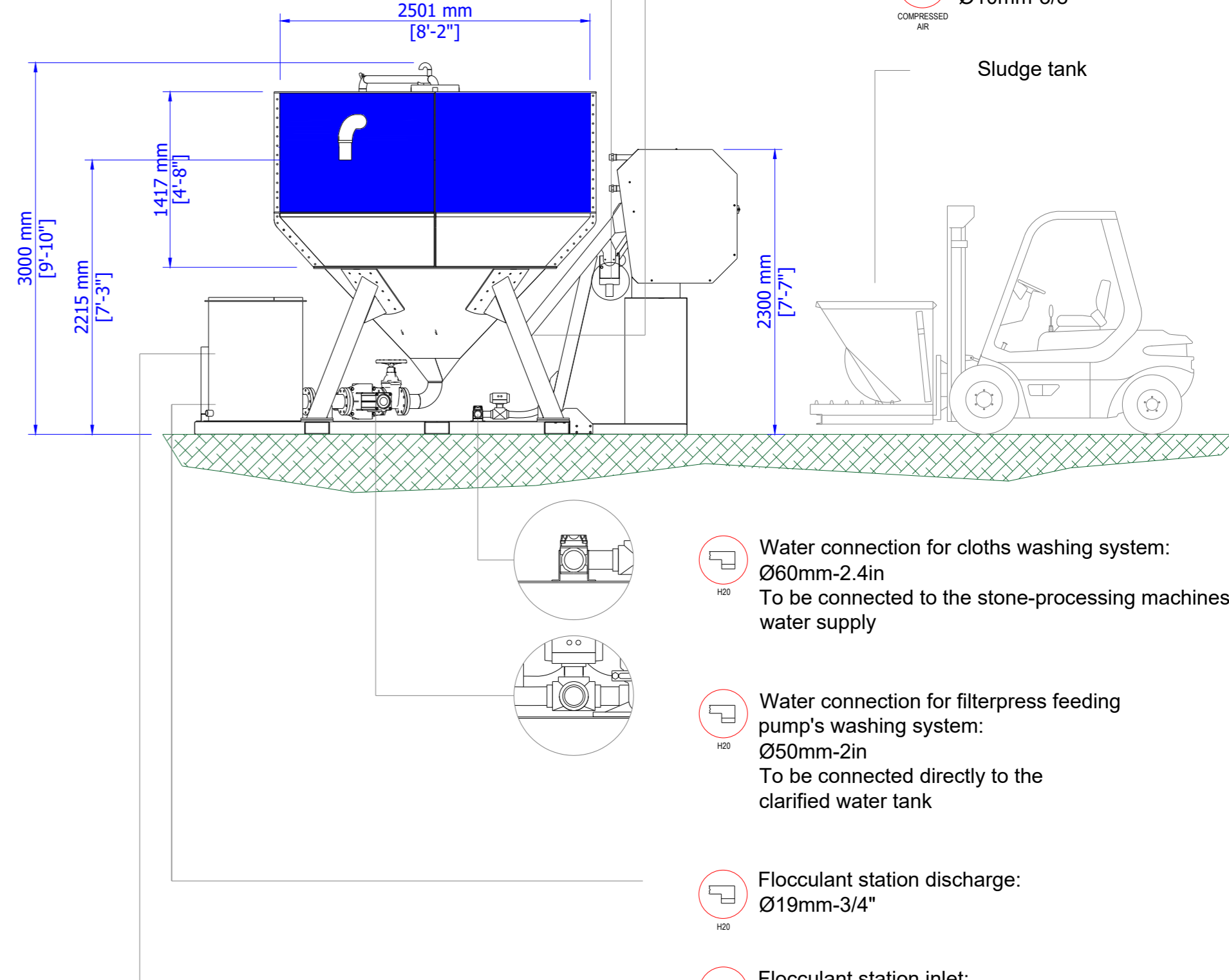

Water connection for cloths washing system:
Ø60mm-2.4in
To be connected to the stone-processing machines' water supply

Water connection for filterpress feeding pump's washing system:
Ø50mm-2in
To be connected directly to the clarified water tank

Flocculant station discharge:
Ø19mm-3/4"

Flocculant station inlet:
Ø19mm-3/4"
Use pure water only

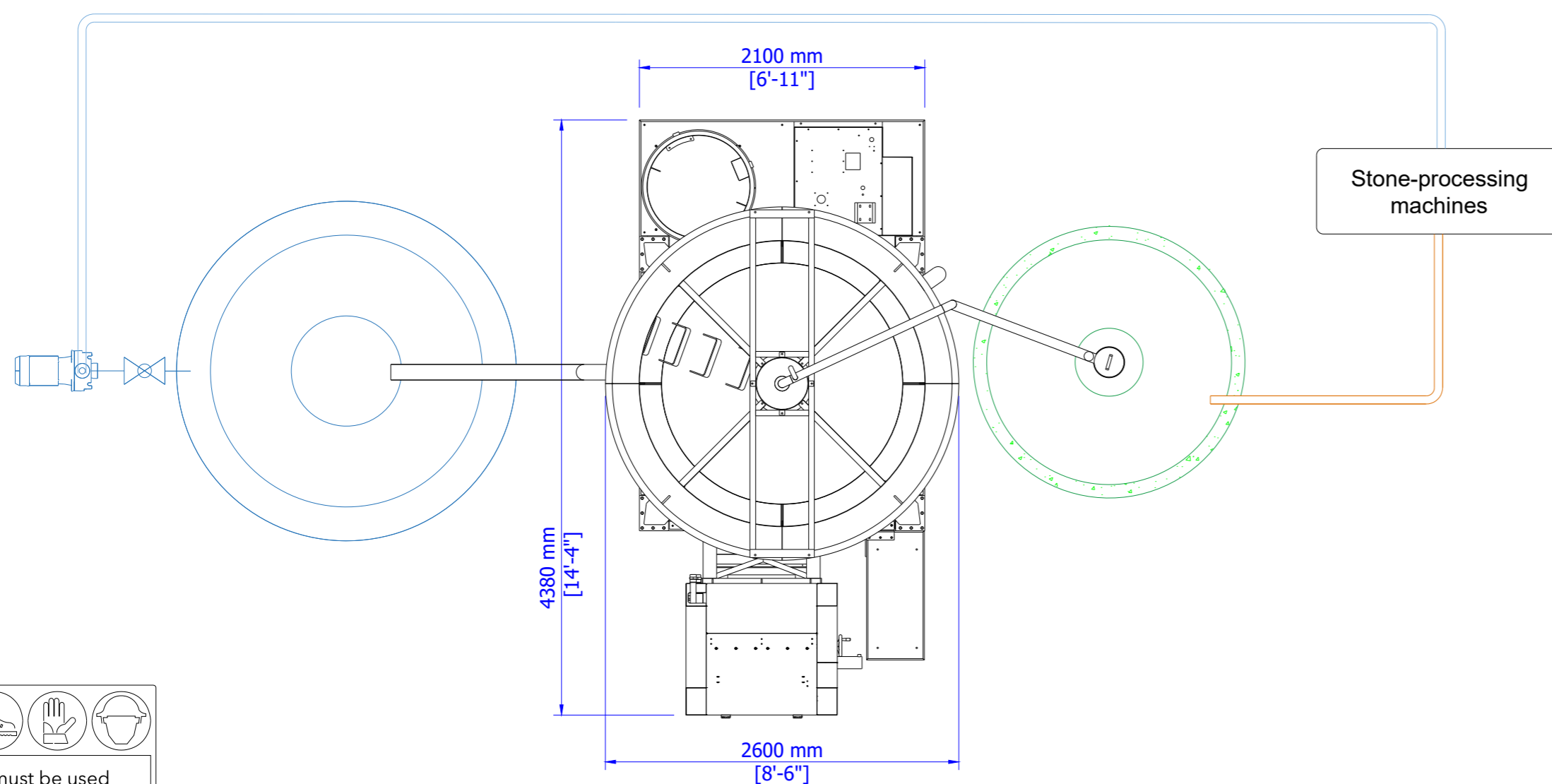

MACCHINA TIPO:
MACHINE TYPE:

Water clarification and sludge dehydration plant

MINI COMPACT M 3.1 R

Serial Number: _ _ _ - _ _ _

CLIENTE:
CUSTOMER:

CODICE DISEGNO
(drawing code)

DATA
(date)

APPROVATO
(approved)



P.P.E. must be used

