

Drainage channel pipe:
Ø60mm-2.4in

Sludge tank

Electric supply connection:
AC 400V; 50HZ; 6,5kW; 15A
3PH + PE

Compressed air supply:
Ø10mm-3/8"

Flocculant station
discharge:
Ø19mm-Ø3/4"

Flocculant station inlet:
Ø19mm-Ø3/4"
Use pure water only.

Water connection for cloths
washing system:
Ø60mm-2.4in
To be connected to the stone-processing
machines' water supply

Clarified water
unloading pipe:
Ø102mm-4in

Wastewater
loading pipe:
Ø60 mm-2.4in

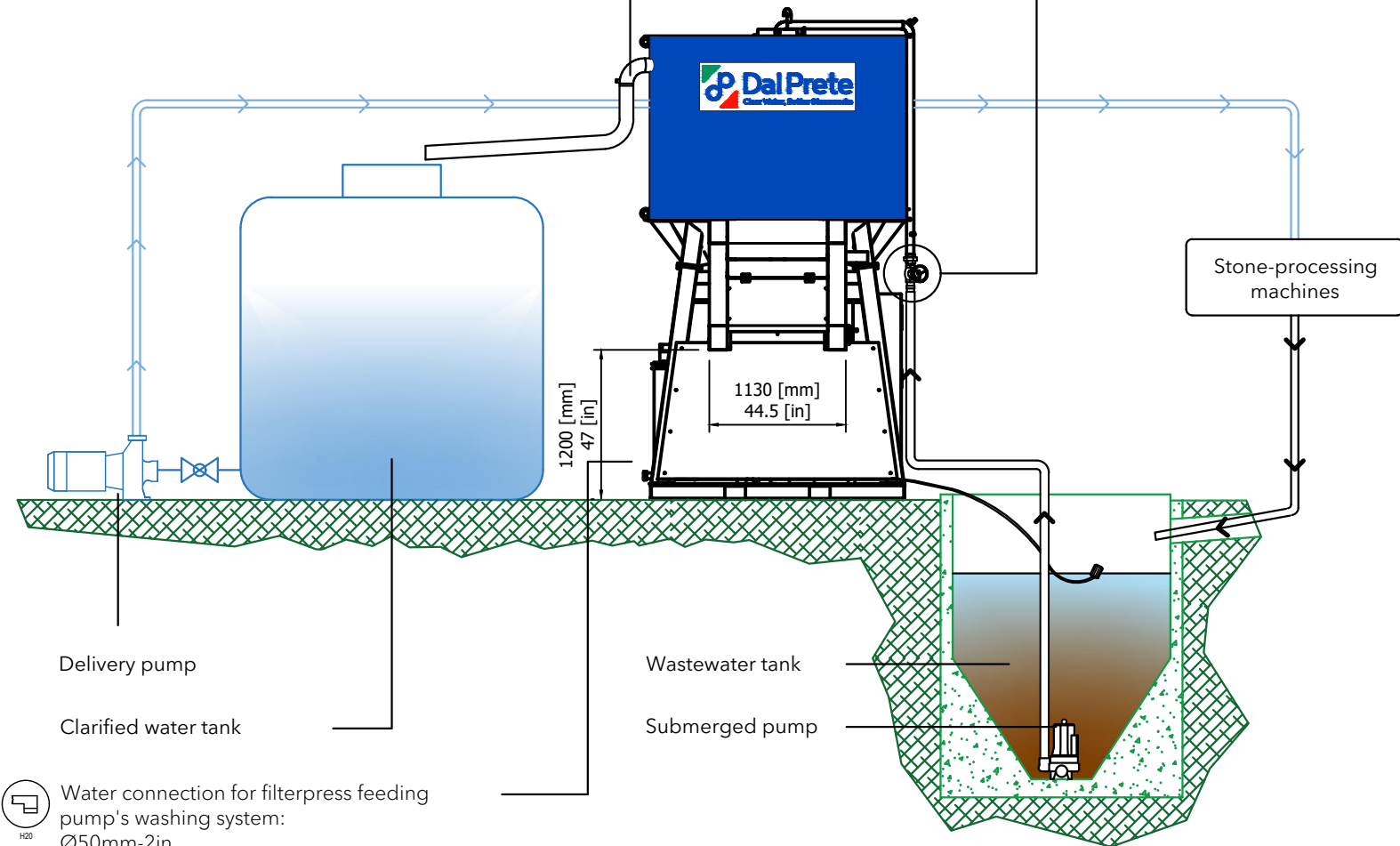

Delivery pump

Clarified water tank

Wastewater tank

Submerged pump

Stone-processing
machines

Water connection for filterpress feeding
pump's washing system:
Ø50mm-2in
To be connected directly to the
clarified water tank

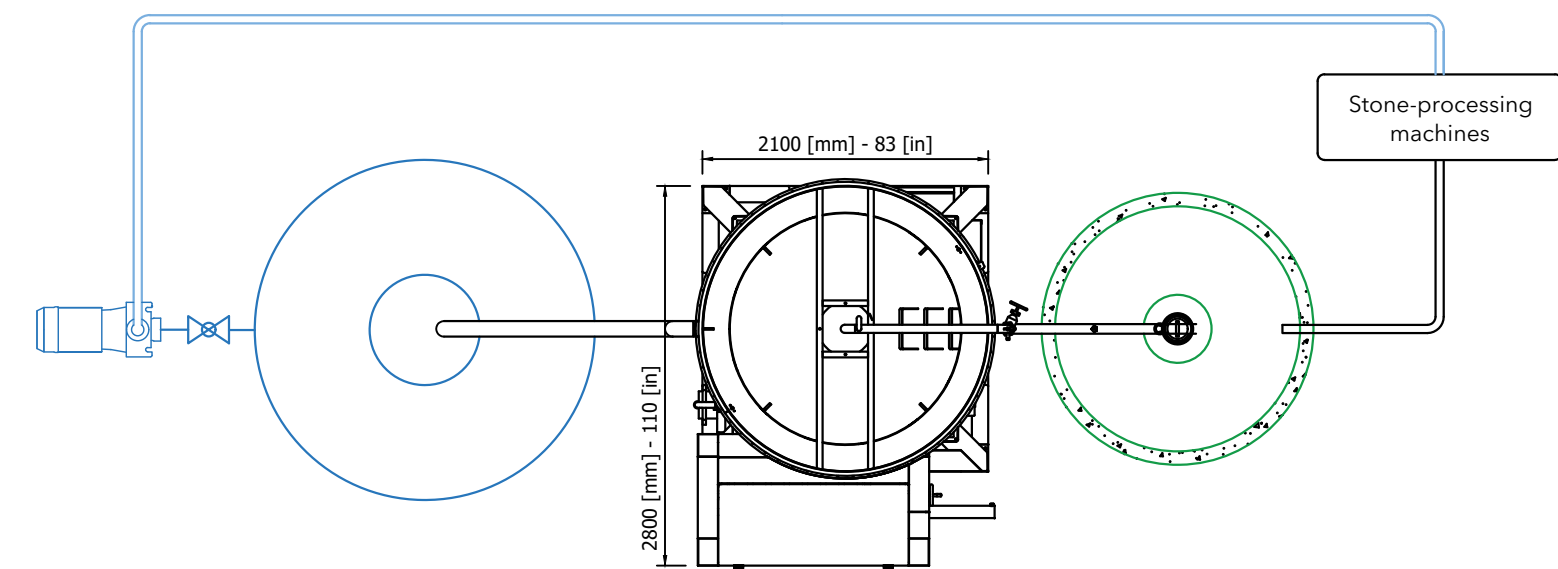

Stone-processing
machines

MACCHINA TIPO:
MACHINE TYPE:

Water clarification and sludge dehydration plant

MINI COMPACT M 3.1

Serial Number: _ _ _ - _ _ _

CLIENTE:
CUSTOMER:

LAY-OUT DI MASSIMA
(plant lay-out)

CODICE DISEGNO
(drawing code)

DATA
(date)

APPROVATO
(approved)

